



ES9-12TE

SPECIFICATIONS

Nominal Voltage (V) 12V

Nominal Capacity

15 min rate (216W to 9.60V)	36Wh
20 hour rate (0.45A to 10.50V)	9Ah
10 hour rate (0.855A to 10.50V)	8.55Ah
5 hour rate (1.53A to 10.20V)	7.65Ah
1C (9A to 9.60V)	5.7Ah
3C (27A to 9.60V)	3.6Ah

Weight Approx. 5.94Lbs. (2.7kg)

Internal Resistance (at 1KHz) 14.5 mΩ

Maximum Discharge Current for 5 seconds : 180A

Operating Temperature Range

Charge	-15°C (5°F) to 40°C (104°F)
Discharge	-15°C (5°F) to 50°C (122°F)
Storage	-15°C (5°F) to 40°C (104°F)

Charge Retention (shelf life) at 20°C (68°F)

1 month	92%
3 months	90%
6 months	80%

Charging Methods at 25°C (77°F)

Cycle Use : Charging Voltage 14.4 to 15.0V
Maximum Charging Current : 2.7A

Standby Use : Float Charging Voltage 13.50 to 13.80V

Life expectancy :

Cycle Use :	100% depth of discharge	225 cycles
	80% depth of discharge	250 cycles
	50% depth of discharge	750 cycles

Standby Use : 3-5 years

Case Material :

ABS
(Option : 94-V0 Flame Retardant Case/Cover)

Terminal :

F3

Maintenance-Free Rechargeable Sealed Lead-Acid Battery



DIMENSIONS

mm(inch)

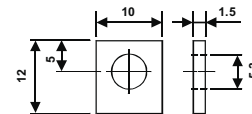

F3
(M5 Bolts)

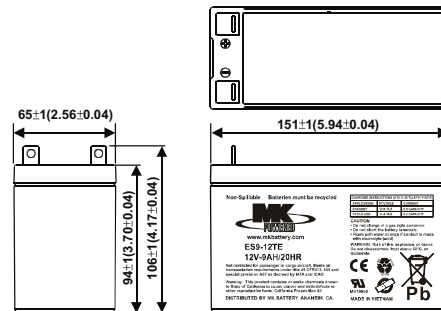

(V) FOR 12V BATTERY

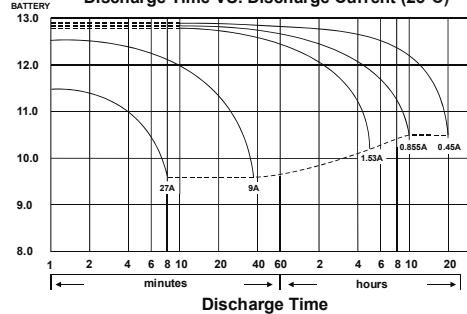

MK Battery

1631 South Sinclair Street • Anaheim, California 92806

Toll Free: 800-372-9253 • Fax: 714-937-0818 • E-mail: sales@mkbattery.com

